

# SPS-SERIES

## Low Voltage Disconnection Unit for Batteries 12V, 24V and 48V

SPS-series has been designed for battery back-up power supply systems to protect the batteries against hazardous deep discharges. The protector disconnects the load from the batteries, when voltage goes down to critical limit for the battery. The LVD will extend lifetime of the battery and eliminates the unnecessary service and early change of the battery.

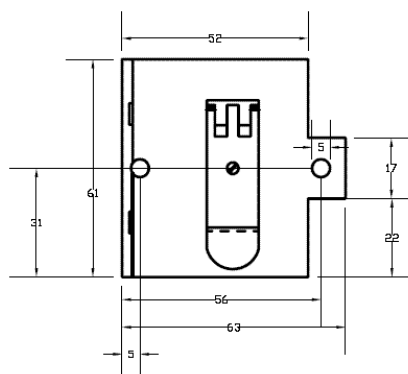
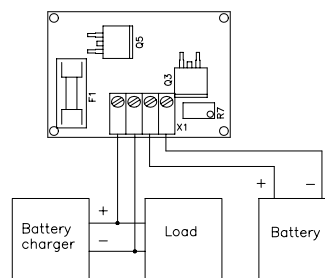
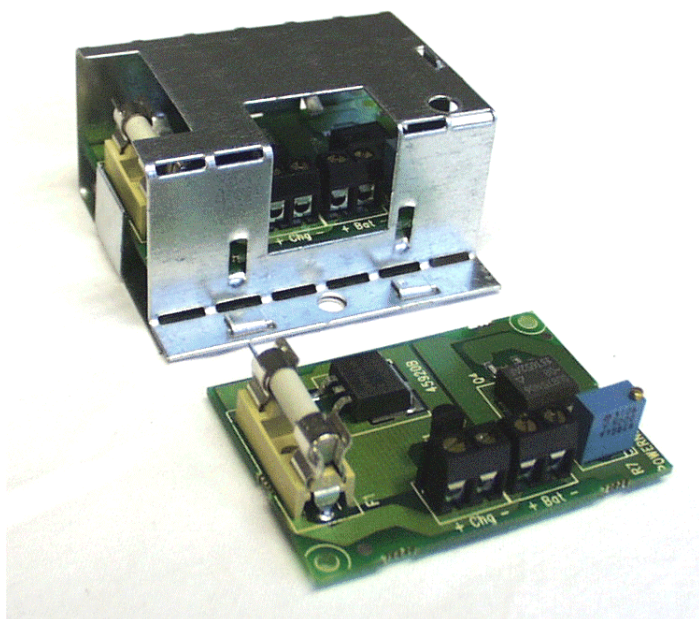

Bottom dimensions

Type	Battery Voltage	Current Rating	Load Disconnection	Load Re-connection	Disconnected Line	Dimensions (wall mounting brackets included)
SPS4590	12 V	10 A	10...11 V	Udis + 0,7 V	+ and - line	61 x 61 x 30 mm
SPS4700	24 V	10 A	20...22 V	Udis + 1,4 V	+ and - line	61 x 61 x 30 mm
SPS4710	48 V	10 A	40...44 V	Udis + 2,8 V	+ and - line	61 x 61 x 30 mm
SPS7512	12 V	20 A	10...11 V	Udis + 0,8 V	+ line	61 x 61 x 30 mm
SPS7514	24 V	20 A	20...22 V	Udis + 1,2 V	+ line	61 x 61 x 30 mm
SPS7510	48 V	20 A	40...44 V	Udis + 1,8 V	+ line	61 x 61 x 30 mm

Installation	DIN-rail or wall mounting
Enclosure	IP10 metal enclosure (optional open card)
Operating temperature	-40...+55C°
Connectors	10A models 2.5 mm <sup>2</sup> screw terminals, 20A models 4 mm <sup>2</sup> screw terminals
Protection	10A models Fuse 10A, 20A models fuse 20A



# POWERNET



Sales & R&D: Mäkituvantie 3 H, FIN-01510 VANTAA, Tel. +358 9 8362 830, Fax +358 9 8362 8362  
 Production and Service: Rautatiekatu 52, FIN-44150 ÄÄNEKOSKI, Tel. +358 14 3396 400, Fax +358 14 3396 410  
 E-mail: marketing@powernet.fi, Internet: www.powernet.fi